

# Vejledning til ETA-ansøgning til Kenya

Ansøg om ETA online her: <https://www.etakenya.go.ke/en>

Som rejsende til Kenya med dansk statsborgerskab, er der krav om ETA for indrejse. Vi anbefaler du ansøger via ETA Kenyas hjemmeside.

Vejledningen her hjælper dig gennem ansøgningen step for step. Det er dog dit eget ansvar, at ansøgningen er udfyldt korrekt og godkendt inden afrejse.

## For ansøgning om ETA gælder følgende regler:

- Dit pas skal være gyldigt i 6 måneder fra datoen for indrejsen
- Dit ETA gælder i 90 dage fra datoen, hvor dit ETA er godkendt og udstedt (vi anbefaler derfor, at du ikke ansøger for tidligt). ETA koster ca. 32,5 USD pr. person og 1,5 USD i servicegebyr
- Børn skal også ansøge om ETA. Det er muligt at lave en gruppeansøgning, hvor der søges om ETA for alle medrejsende samtidigt.

## Inden du ansøger om ETA, bedes du forberede nedenstående dokumenter, som skal vedhæftes i selve onlineansøgningen som JPEG-filer:

- Rejsedokumenter (din billet fra Bravo Tours / Bravo Safari)
- Billede af fotosiden i dit pas
- Selfie / Portrætbillede. Det er muligt at tage billedet undervejs i ansøgning med dit webcam

## Du betaler og afslutter med kreditkort eller Google Pay.

**Bemærk:** Vi anbefaler du bruger Google Chrome som browser og IKKE oversætter til dansk. Vær desuden opmærksom du ikke kan benytte æ, ø og å - benyt i stedet ae, oe og aa.

**Du SKAL  
medbringe  
dit ETA  
udprintet i  
farver**

Gå til  
<https://www.etakenya.go.ke/en>  
og klik på **Apply Now**

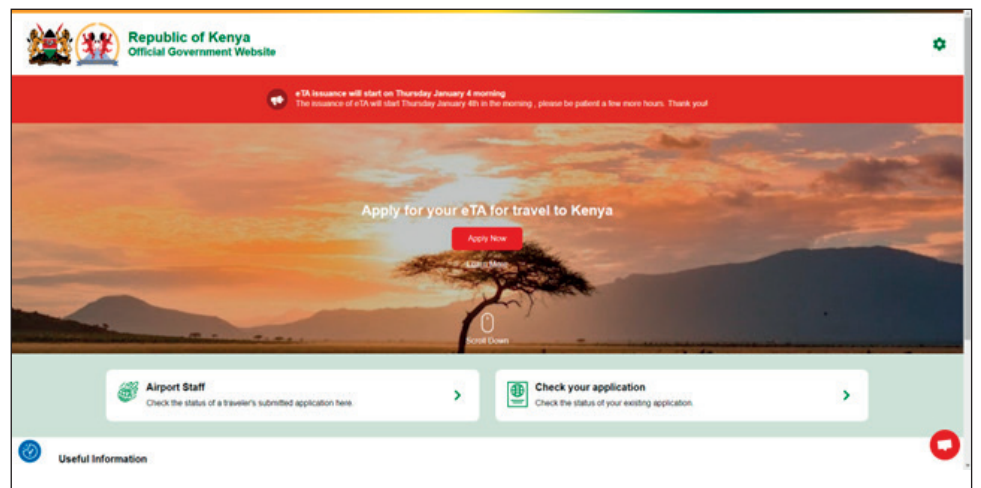

Klik på  
**Continue**

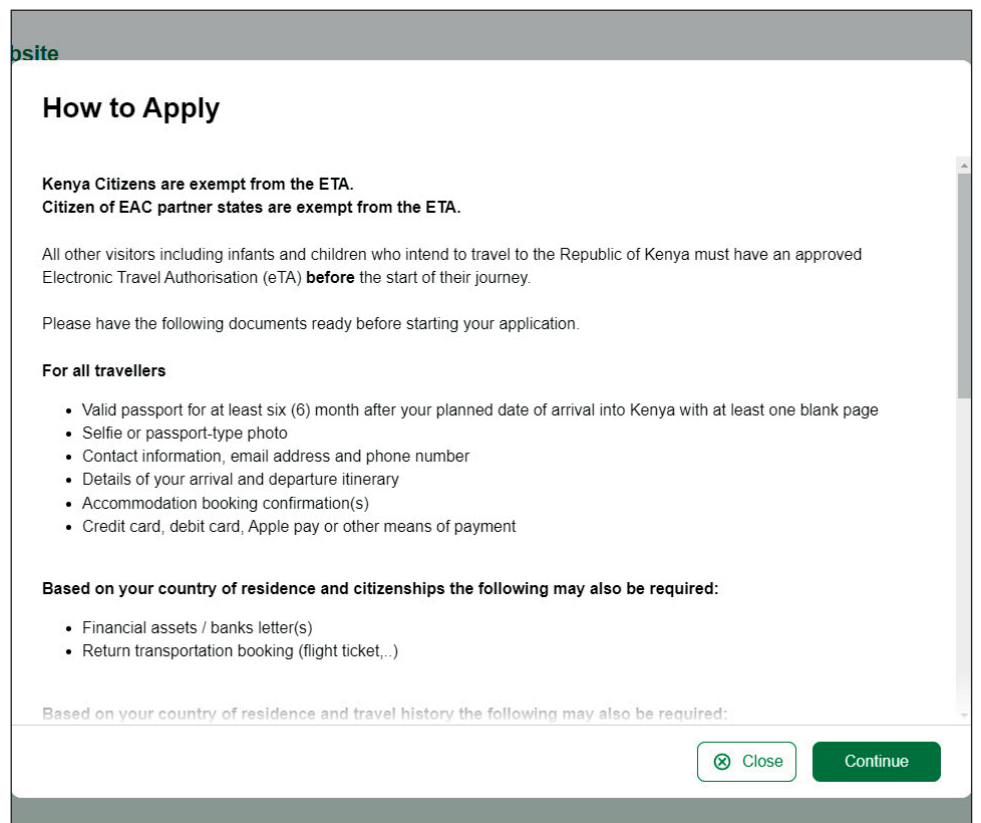

Tjek boksen **I have read and greed to the above.** (Jeg har læst og forstået ovenstående) og klik på **Continue.**

### Declaration of Consent

Kenya eTA is a semi-automated system that determines the eligibility of visitors to travel to Kenya.

This website and mobile application are operated by the Ministry of Interior and National Administration – Directorate of Immigration Services of the Government of the Republic of Kenya pursuant to the rules and regulations prescribed by the Republic of Kenya Data Protection laws to ensure the privacy of your information.

Information submitted by applicants through the Republic of Kenya eTA is subject to privacy provisions and controls similar to those that have been established elsewhere for similar traveller screening programs. Access to such information is limited to those persons who have a need to know, and are recognized and approved by the Government of the Republic of Kenya.

Please refer to the Terms and Conditions of Use, General Information, Privacy Policy and FAQ for more details.

Please note that the Government of the Republic of Kenya has determined that the processing of your data is in the public interest.

Please note that by submitting an application for an eTA and clicking on the button below, you authorise the Directorate of Immigration Services, and its agents, and other Ministries and Services duly authorised by the Republic of Kenya to use your personal information for the purpose of determining your eligibility to travel to the Republic of Kenya and to contact you before, during and/or after your trip via such means as it/they deem necessary and appropriate in order:

1) to obtain from you information necessary to clarify certain elements of your application;  
2) to send you information about your application status and related documents.

**I have read and agreed to the above.**

Opt-in to receive special offers and exciting updates for your trip.

[Close](#) [Continue](#)

Vælg **Individual application**, hvis du rejser alene.

Vælg **Group application** hvis du rejser to eller flere sammen.

Vejledningen herefter er group application, hvorfor der kan være mindre variationer, hvis du rejser alene. Vær opmærksom på, at det kun er muligt at lave en gruppeansøgning, hvis alle i gruppe er

- Fra samme oprindelsesland
- Besøger Kenya med samme formål
- Rejser på samme fly og skal bo på samme hotel under rejsen



### Individual application

I am applying for one individual only.



### Group application

I am applying for a group application.

If you are a family, a couple, friends living together or a company submitting on behalf of your employees, you can save time by applying as a group. To apply as a group, you must meet certain eligibility requirements.

Klik på **Continue**

### Eligibility Checklist for Family/Couples Applications

If you are a family, a couple, or friends travelling together in a group of up to nine (9) travellers, you can save time by applying together.

Select the "Group Application" option on the eTA website or mobile app and follow the instructions. On approval, each member of the group will receive their own Electronic Travel Authorisation. If there are more than 9 travellers in your group, please apply as 2 or more groups.

All individuals in the group application must:

- Share the same country of residence.
- Share the same purpose of visit to the Republic of Kenya.
- Share the same travel (flight, cruise, ...) and accommodation itinerary for their entire trip to and stay in the Republic of Kenya.

**If you expect to travel to Kenya regularly or have multiple trips planned, we highly encourage you to download the "Kenya Travel Authorisation" mobile app that will be made available in January. You will be able to securely save your travel documents and profile on your phone which can be reused for future travel.**

Close Continue

### Country of Residence



Vælg **Denmark** og klik på **Continue**

### Country of Residence

Please select your country of residence. This is the country where you live and pay taxes. If you are a resident Diplomat of Kenya, please select Kenya.

Den

#### All Countries

-  Denmark
-  Sweden

## 1. Trip Information

The screenshot shows a web form titled "Trip Information" with a sub-header "Please select your country". The form is organized into several sections:

- ARRIVAL DETAILS:** Includes a dropdown for "Country of origin", a date picker for "Arrival Date", a dropdown for "Airline", and a text field for "Tail Number". A green button labeled "+ ADD ADDRESS" is visible.
- DEPARTURE DETAILS:** Includes a date picker for "Departure Date", a dropdown for "Destination Country", and a text field for "Address(es) in Kenya". A green button labeled "+ ADD ADDRESS" is visible.
- ADDITIONAL DETAILS:** Includes a text field for "Other Details" and a green button labeled "Continue".

### Primary purpose of visit

Vælg **Tourism**

### Arrival Details

**Arrival Date:** Vælg ankomstdato til Kenya med kalenderen

**Select airline:** Vælg flyselskab fra listen. Flyver du med Jettime, vælg da Private Jet.

**Tail Number:** Indtast flynummer (fremgår af din billet)

**Select the country of origin for your trip:** Vælg afrejseland

### Departure Details

**Departure Date:** Primary purpose of visit/afrejsedato fra Kenya med kalenderen

**Destination Country:** Vælg hjemrejseland

### Address(es) in Kenya

Brug feltet med luppen til at søge efter dit hotel. Brug kalenderen til at vælge dato for check-in og check-ud.

Har du både safari og badeferie, og skal derfor bo flere steder under rejsen, anbefaler vi, at du kun vælger dit hotel ved kysten og anfører, at det er her du bor under hele ferien.

Er du udelukkende på safari og skal bo på flere lodges, skal du bruge knappen **+ ADD ADDRESS** og tilføje alle hoteller, du bor på under rejsen.

Klik på **Continue**

## 2. Passport Information for Your Group

Klik på **Upload Passport Page** og upload et billede af dit pas (billedsiden) eller brug kameraet til at tage et billede.

**Passport Information for Your Group**

For each member of your group, please provide a photo or scan of the first page of their passport with their photo on it.

- ✓ Trip Information
- Passport Information for Your Group
- Contact Information
- General Info
- Customs Declaration
- Required Documents
- Confirm and Proceed

Drag & drop a photo or scan of the required document or click here to manually select.

**Upload Passport Page** **Use Webcam**

**Close** **Continue**

Dine data bliver læst automatisk.

Tjek boksen **I have reviewed the name and date of birth as scanned from this identity document along with its number and expiry date and confirm that it is correct** hvis informationen er korrekt.

Klik på **Take a Selfie**.

**Passport Information for Your Group**

For each member of your group, please provide a photo or scan of the first page of their passport with their photo on it.

+ Add Another Individual

**Take a Selfie**

I have reviewed the name and date of birth as scanned from this identity document along with its number and expiry date and confirm that it is correct.

**Take A Selfie**

+ Add Another Individual

**Close** **Save & Exit** **Continue**

Vælg **Get Started** for at tage et billede med dit computerkamera eller vælg **Upload Selfie Instead** for at uploade en selfie fra din computer.

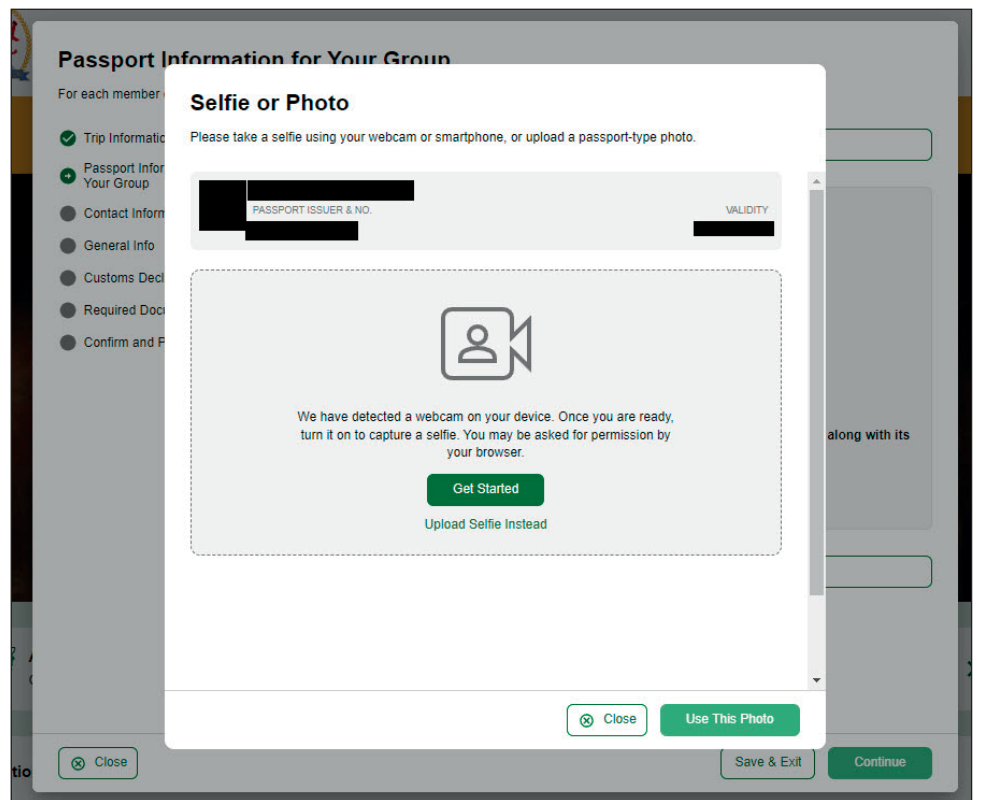

Bruger du kameraet i din computer, kan du vælge mellem tre billeder. Vælg det bedste og klik på **Use This Photo**.

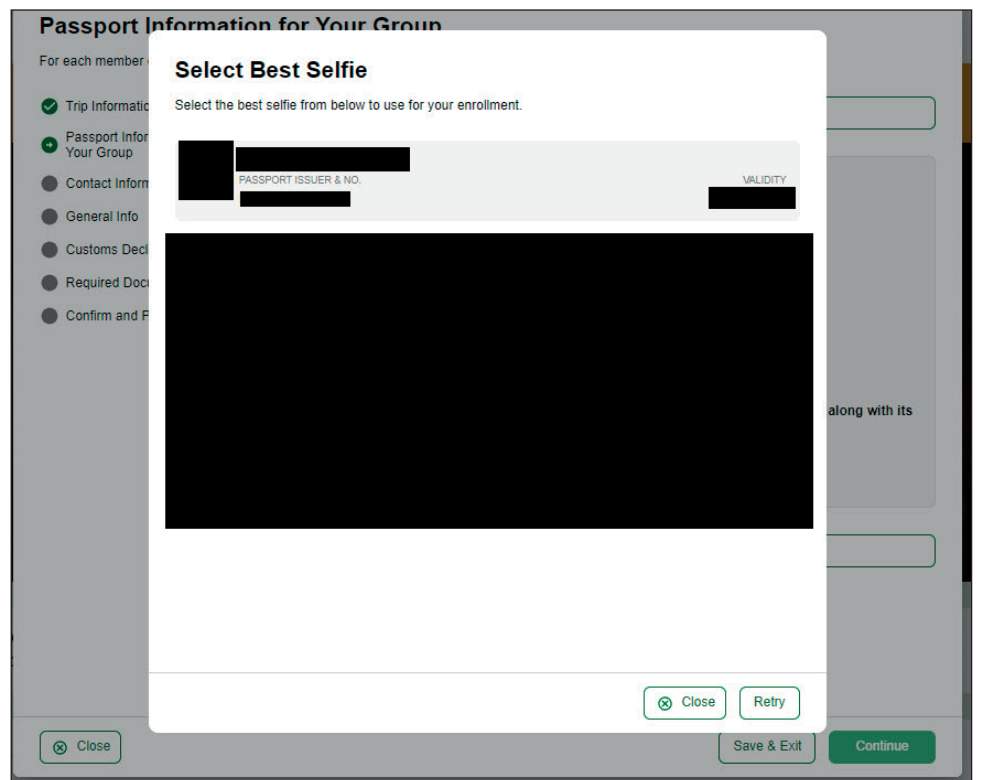

Skal du tilføje flere medrejsende, skal du bruge knappen **+ Add Another Individual**

Klik på **Continue**

**Passport Information for Your Group**

For each member of your group, please provide a photo or scan of the first page of their passport with their photo on it.

- ✓ Trip Information
- Passport Information for Your Group
- Contact Information
- General Info
- Customs Declaration
- Required Documents
- Confirm and Proceed

+ Add Another Individual

FULL NAME  
DOCUMENT NUMBER  
DATE OF BIRTH  
VALIDITY

I have reviewed the name and date of birth as scanned from this identity document along with its number and expiry date and confirm that it is correct.

Take A Selfie

+ Add Another Individual

Close Save & Exit Continue

### 3. Contact Information

**Phone Number:** Indtast dit telefonnummer

**Email:** Indtast din email

**Search Places in Denmark:**

Brug søgefunktionen til at finde din adresse i Danmark. Kan den ikke finde den præcise adresse, skal du blot vælge by/område.

**Select Occupation:**

Vælg beskæftigelse fra menuen

Email: Indtast din email

**Emergency Contacts (optional)**

Indtast navn og telefonnummer på en kontaktperson ved nødstilfælde (frivilligt)

Klik på **Continue**

**Contact Information**

We require this information to process your application and get in contact with you if we have any questions or need more information.

- ✓ Trip Information
- ✓ Passport Information for Your Group
- Contact Information
- General Info
- Customs Declaration
- Required Documents
- Confirm and Proceed

+45 Phone Number

Email

Search Places in Denmark

If you don't find your street address, please enter your neighborhood, city and country.

Select Occupation

**Emergency Contacts (optional)**  
Please specify at least one emergency contact.

Full Name of Emergency Contact

+45 Phone Number

+ Add Contact

Close Save & Exit Continue



## 4. General information

### General Information

Please answer the following questions to complete your enrollment with general information we require to complete review of your enrollment.

- ✓ Trip Information
- ✓ Passport Information for Your Group
- ✓ Contact Information
- ➔ General Info
- Customs Declaration
- Required Documents
- Confirm and Proceed

What is your country of birth?

What was your nationality at birth?

What is your Marital Status?

Single  Married  Divorced  Widowed

Have you previously traveled to Kenya?

Yes  No

Have you ever been previously denied entry to Kenya?

Yes  No

Have you ever been convicted of any offence, under any system of law, in the past 5 years?

Yes  No

Is your trip financed by a third party, which is not your employer nor a government?

Yes  No

**What is your country birth?:** Vælg fødselsland

**What was you nationality at birth?:** Vælg din nationalitet ved fødslen

**What is your Marital Status?:** Vælg din civilstatus (Single = Single, Married = Gift, Divorced = Fraskilt eller Widowed = Enke)

**Have you previously traveled to Kenya?:** Har du tidligere været i Kenya? Vælg Yes = Ja eller No = Nej

**Have you ever been previously denied entry to Kenya?:** Er du tidligere blevet nægtet adgang til Kenya? Vælg Yes = Ja eller No = Nej

**Have you ever been convicted of any offence, under any system of law, in the past 5 years?:**

Er du inden for de seneste 5 år dømt ved nogen domstol? Vælg Yes = Ja eller No = Nej

**Is your trup financed by a third party, which is not your employer nor a government?:** Er din rejse finanseret af en 3. part som ikke er din arbejdsgiver eller et ministerium/regering? Vælg Yes = Ja eller No = Nej

Klik på **Continue**

### Will you be bringing into Republic of Kenya currency or monetary instruments of a value greater than \$5000 or foreign equivalent?

Medbringer du værdier (penge eller papirer) til en værdi a 5.000 USD eller højere?

Vælg Yes = Ja eller No = Nej

Klik på **Continue**

**Customs Declaration**  
Answer a few questions related to biosecurity, customs and law enforcement

- ✓ Trip Information
- ✓ Passport Information for Your Group
- ✓ Contact Information
- ✓ General Info
- ➔ **Customs Declaration**
- Required Documents
- Confirm and Proceed

Will you be bringing into Republic of Kenya currency or monetary instruments of a value greater than \$5000 or foreign equivalent?

Yes  No

## 5. Require Documents

### Accommodation Booking Confirmations

Klik på **Select File** og upload din billet fra Bravo Tours / Bravo Safari

### Airline Booking Confirmations

Klik på **Select File** og upload din billet fra Bravo Tours / Bravo Safari

Klik på **Continue**

**Required Documents**  
Please upload the required document(s) below.

- ✓ Trip Information
- ✓ Passport Information for Your Group
- ✓ Contact Information
- ✓ General Info
- ✓ Customs Declaration
- ➔ **Required Documents**
- Confirm and Proceed

**Accommodation Booking Confirmations**  
Upload your booking confirmation(s) for your place of stay. This must include the name of the hotel/guesthouse. If you're visiting friends and family, provide the name, ID or passport number, and mobile phone number of your host.

**Airline Booking Confirmation**  
Upload your airline/cruise booking confirmation(s) which clearly shows your name and arrival/departure flight details.

## 6. Confirm and Proceed

Tjek boksen **I am the applicant and I understand and agree that this declaration is final and irrevocable and accept to digitally sign this request**

(Jeg er ansøgeren og jeg forstår og acceptere at denne erklæring er endelig og uigenkaldelig og acceptere at underskrive denne ansøgning digitalt).

Klik på **Continue**

### Confirm and Proceed

- ✓ Trip Information
- ✓ Passport Information for Your Group
- ✓ Contact Information
- ✓ General Info
- ✓ Customs Declaration
- ✓ Required Documents
- ➔ Confirm and Proceed

Please make sure all information you are submitting is complete, updated and accurate. You can review and edit the information by clicking on the relevant sections. By proceeding, you a) declare that all the information you have provided is true and complete and you understand that you are committing an offense if you knowingly omit or give false information. b) you understand that an approved eTA does not determine whether a traveller is admissible to enter Kenya. Immigration officers will determine admissibility upon travellers' arrival. c) you understand that providing false or incomplete information may result in the rejection of your travel authorisation. d) you understand that if this application is made by an agent or automated system of a third party website, it may be automatically denied and no refund will be due. e) that if you are granted entry into Kenya, you will need to agree to comply with national laws of the Republic of Kenya.

I am the applicant and I understand and agree that this declaration is final and irrevocable and accept to digitally sign this request.

I am NOT the applicant and I am completing this form on behalf of someone. I do understand and agree that this declaration is final and irrevocable and accept to digitally sign this request.

**Additional Notes**

Please add any additional information that you believe would help us better process your application.

**Enable Notifications? When notifications are enabled, we send a notification to your device when your application(s) are reviewed and approved.**

(Tillad notifikationer? Når notifikationer er aktiveret, sender vi en notifikation til din enhed, når din(e) ansøgning(er) er gennemgået og godkendt.)

Klik på **Continue**

### Confirm and Proceed

- ✓ Trip Information
- ✓ Passport Information for Your Group
- ✓ Contact Information
- ✓ General Info
- ✓ Customs Declaration
- ✓ Required Documents
- ➔ Confirm and Proceed

Please make sure all information you are submitting is complete, updated and accurate. You can review and edit the information by clicking on the relevant sections. By proceeding, you a) declare that all the information you have provided is true and complete and you understand that you are committing an offense if you knowingly omit or give false information. b) you understand that an approved eTA does not determine whether a traveller is admissible to enter Kenya. Immigration officers will determine admissibility upon travellers' arrival. c) you understand that providing false or incomplete information may result in the rejection of your travel authorisation. d) you understand that if this application is made by an agent or automated system of a third party website, it may be automatically denied and no refund will be due. e) that if you are granted entry into Kenya, you will need to agree to comply with national laws of the Republic of Kenya.

I am the applicant and I understand and agree that this declaration is final and irrevocable and accept to digitally sign this request.

I am NOT the applicant and I am completing this form on behalf of someone. I do understand and agree that this declaration is final and irrevocable and accept to digitally sign this request.

**Additional Notes**

Please add any additional information that you believe would help us better process your application.

**Enable Notifications?**

When notifications are enabled, we send a notification to your device when your application(s) are reviewed and approved.

## Application Processing Period

Tjek boksen **Standard Processing**  
(Pris: 32,50 USD).

Klik på **Continue**

### Application Processing Period

Based on your travel date, select the corresponding processing time.

- Application Processing Period
- Complete your Application

**Standard Processing** USD 32.50

- Your application will be processed within 72 hours
- Basic support
- If your application is incomplete you will be denied.

[Complete](#)

## Complete you Application

Vælg mellem kortbetaling eller Google Pay. Vælger du kortbetaling, skal du indtaste dit kortnummer, udløbsdato og CVC-kode.

Klik på **Pay**.

### Complete your Application

Pay safely and securely using one of the payment methods below. All application fees and donations are non-refundable and non-transferrable. Third party providers' terms & conditions and refund policies apply

- Application Processing Period
- Complete your Application

Card

Google Pay

Card number: 1234 1234 1234 1234

Expiration: MM / YY  CVC:

Country: Denmark

Total USD 34.09 [View Summary](#)

[Pay](#)

Under **Important Information** er der et link. Klik på kopiér knappen markeret i den røde firkant. Indsæt linket i et nyt vindue i din browser og gem det. Det er via dette link, du kan tjekke din ansøgnings status.

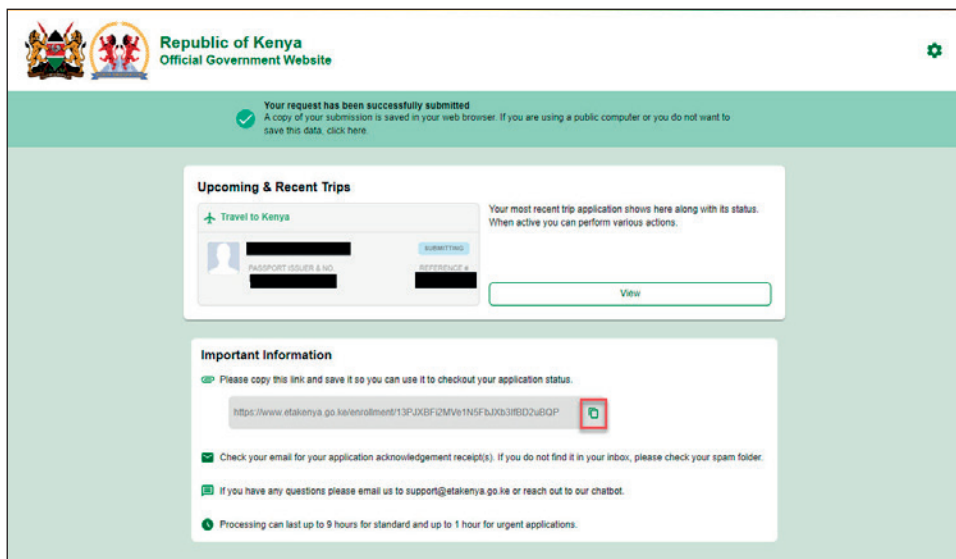

Det er via dette link, du kan tjekke din ansøgnings status. Processing = Under behandling.

**Når statussen skifter til godkendt, skal du huske at udprintet dit ETA og medbringe det fysisk på rejsen.**

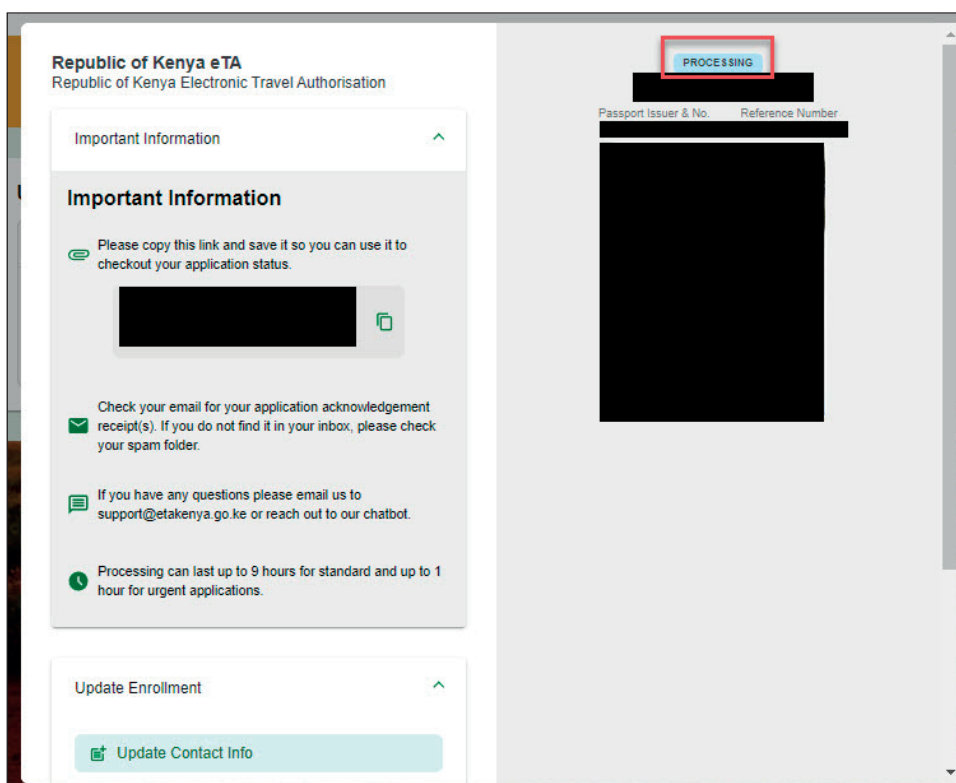

**Du SKAL medbringe dit ETA udprintet i farver**